

**WYOMING CENTRAL SCHOOL DISTRICT**  
**2023 PROPOSED CAPITAL CONSTRUCTION PROJECT**  
Contact Information:  
District Office: 585-495-6222

### Frequently Asked Questions ...

**Q. Why is the district having a Capital Construction Vote?**  
**A.** The Wyoming Central School District is committed to providing a well-maintained facility and a safe learning environment for students and public use. Most of the work included in this proposed Capital Construction Project is "asset preservation." Routine facility maintenance and repair work is typically funded in the annual District budget, with local taxpayers bearing the full cost. However, sizable renovations, repairs and replacement of "end of useful life" items such as those included in this project, would have a MAJOR IMPACT on the tax levy if included in the annual District budget. In fact, it would be virtually impossible to raise enough funds locally to accomplish.

**Q. What is the total cost of the proposed project?**  
**A.** The total cost is \$5,375,000.

**Q. Are there any capital reserve funds being applied to this project?**  
**A.** The district has \$1,500,000 available in "capital reserve" funds. These funds, which the voters approved, allow the District to set aside money to help fund the project.

**Q. How will it affect my taxes?**  
**A.** There will be NO ADDITIONAL IMPACT to your tax levy from the capital construction project. The capital construction project would be paid for using a combination of State Building Aid and the District's Capital Reserves. The Capital Reserves are savings accounts which can be used only for capital construction projects. With the current 2023-2024 State Aid Building Ratio of 80.1% and the District's Capital Reserve funds the capital construction project will not cause an increase in the District's tax levy related to capital purposes.

<p>Wyoming Central School District 1225 State Route 19 PO Box 244 Wyoming NY 14591-0244</p>	<p>NON-PROFIT ORGANIZATION US POSTAGE PAID PERMIT #8 WYOMING NY 14591</p>

# WYOMING CENTRAL SCHOOL DISTRICT 2023 PROPOSED CAPITAL CONSTRUCTION PROJECT INFORMATIONAL MAILER



On December 7, residents of the Wyoming Central School District will have an opportunity to vote on a proposed Capital Construction Project that is focused on preserving this valuable community asset, our school building.

The project is based on the needs assessment required by the New York State Education Department every 5 years to be sure we are planning for and maintaining the district's assets. This Capital Construction Project proposition was designed to meet the needs of the 5-year facility plan. The Board of Education and the Board Capital Project Committee members were involved throughout the process.

- This project is being designed to address 4 key areas:
- ASSET PRESERVATION
  - SAFETY AND SECURITY
  - ENERGY EFFICIENCY
  - ADA ACCESSIBILITY & CODE COMPLIANCE

Capital Construction Projects like these not only help to keep our facilities in good working order, but also to improve the conditions under which our children learn and thrive. The Wyoming Central School District and its Board of Education thank you for your continued involvement and support of our future. This capital project addresses critical needs that are essential to maintaining a safe and functional building. The vote will be held on Thursday, December 7, 2023, from 1 p.m. to 8 p.m. in the main lobby.

Sincerely,  
Emily Herman, and the Board of Education

**VOTE**  
**DECEMBER 7TH,**  
**2023**  
**FROM 1 P.M. TO 8 P.M.**  
**IN THE SCHOOL LOBBY AT**  
**WYOMING CENTRAL**  
**SCHOOL**

- ASSET PRESERVATION
- SAFETY AND SECURITY
- ENERGY EFFICIENCY
- ADA ACCESSIBILITY & CODE COMPLIANCE

## BUS GARAGE



REPLACE OLD BUS LIFT WITH A NEW IN-GROUND BUS LIFT. THE NEW LIFT WILL BE CAPABLE OF LIFTING AN ELECTRIC BUS. THE ELECTRIC BUSES ARE HEAVIER COMPARED TO DIESEL BUSES. THE DISTRICT FEELS IT IS PROACTIVE TO PROVIDE A HIGHER CAPACITY LIFT BECAUSE OF MANDATES FROM THE STATE FOR DISTRICTS TO CONVERT TO ELECTRIC VEHICLES. THE CURRENT BUS LIFT IS ALSO REACHING THE END OF ITS USEFUL LIFE.



CEILING REPLACEMENTS ON SECOND FLOOR



REPLACE P.A. SYSTEM AND SPEAKERS BUILDING WIDE



REPLACE FLOORING IN VARIOUS CLASSROOMS



### DOOR REPLACEMENTS

THE PROPOSED PROJECT WOULD INCLUDE REPLACING MULTIPLE DOORS AND TRANSOMS ABOVE TO ACHIEVE THE REQUIRED FIRE RATING AND IMPROVED THERMAL PERFORMANCE. AESTHETICS WILL REMAIN SIMILAR TO EXISTING.



### LOCKER ROOMS

THE PROPOSED PROJECT WOULD INCLUDE RENOVATING THE FIRST FLOOR LOCKER ROOM INTO 2 ADA ACCESSIBLE LOCKER ROOMS FOR BOYS AND GIRLS. THE LOCKER ROOM ON THE BASEMENT LEVEL WHICH IS NOT ADA COMPLIANT WILL BECOME STORAGE.

**PUBLIC INFORMATIONAL MEETING**  
**NOVEMBER 30TH, 2023**  
**FROM 6 P.M. TO 7 P.M.**  
**IN THE CONFERENCE ROOM AT WYOMING CENTRAL SCHOOL**

**VOTE**  
**DECEMBER 7TH, 2023**  
**FROM 1 TO 8 P.M.**  
**IN THE LOBBY AT WYOMING CENTRAL SCHOOL**

## SCIENCE CLASSROOM



RENOVATE SCIENCE CLASSROOM TO INTEGRATE NEW TECHNOLOGIES RESPONSIVE TO TRENDS IN EDUCATION

RENOVATION INCLUDES NEW CASEWORK (CABINERY), FINISHES SUCH AS A NEW CEILING, PAINTED WALLS, FLOORING AND TECHNOLOGY.

## HOME & CAREERS CLASSROOM



RENOVATE HOME & CAREERS CLASSROOM WITH MODERN TECHNOLOGY AND UPDATED EQUIPMENT.

RENOVATION INCLUDES NEW CASEWORK (CABINERY), FINISHES SUCH AS A NEW CEILING, PAINTED WALLS, FLOORING AND UPDATED EQUIPMENT.

## NEW MAIN ENTRANCE

THE NEW MAIN ENTRANCE WILL IMPROVE ADA ACCESSIBILITY, SAFETY AND SECURITY. THE DISTRICT IS PROPOSING RELOCATION OF THE MAIN ENTRANCE TO THIS NEW LOCATION.



THE NEW ENTRANCE WILL BE SECURE, AND PROVIDE OFFICES FOR NECESSARY STAFF. THE PREVIOUS MAIN OFFICE WILL BECOME AN OFFICE SUITE.

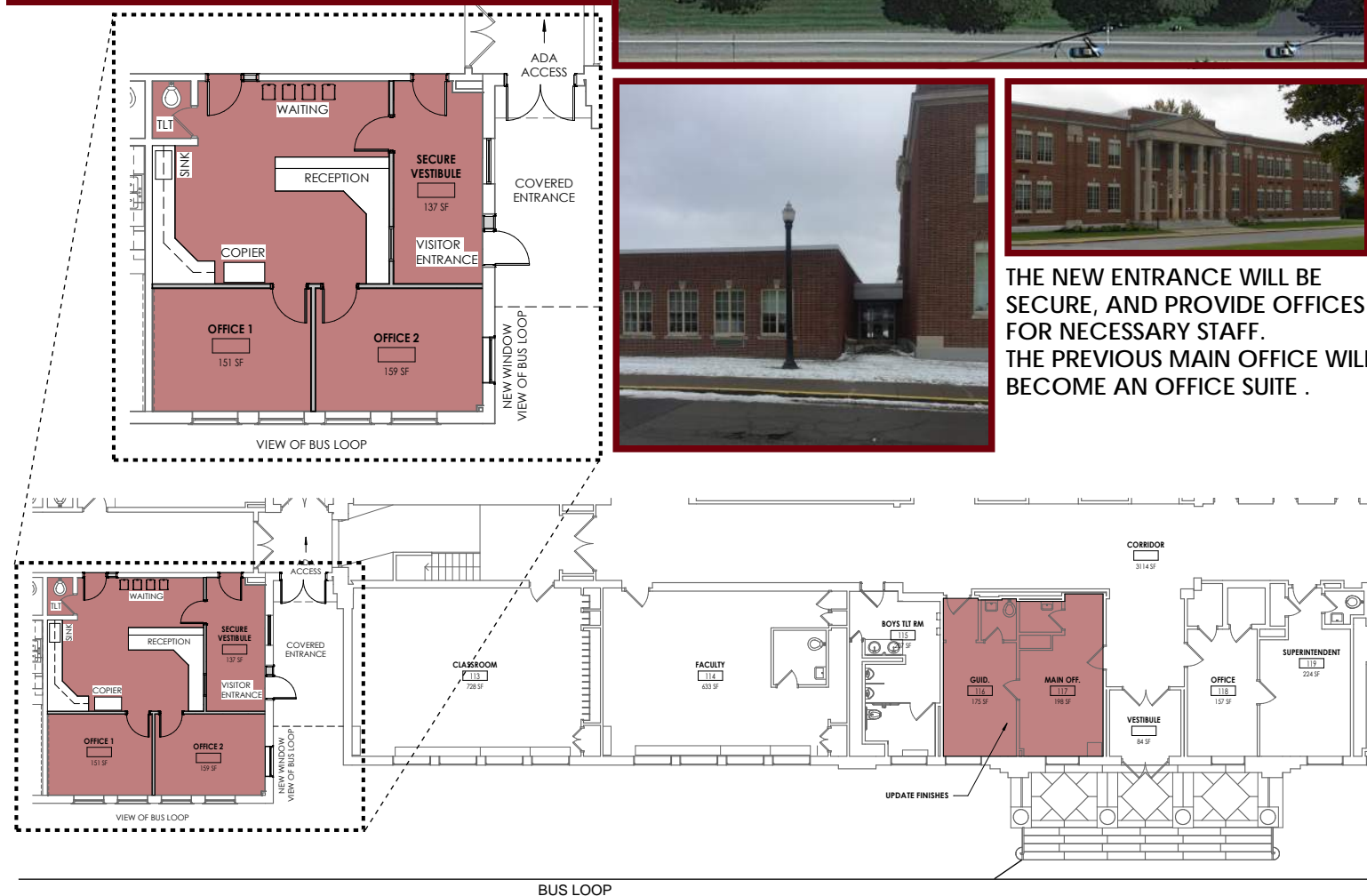

BUS LOOP